

# A Will of Their Own

## NATIONAL PORTRAIT GALLERY

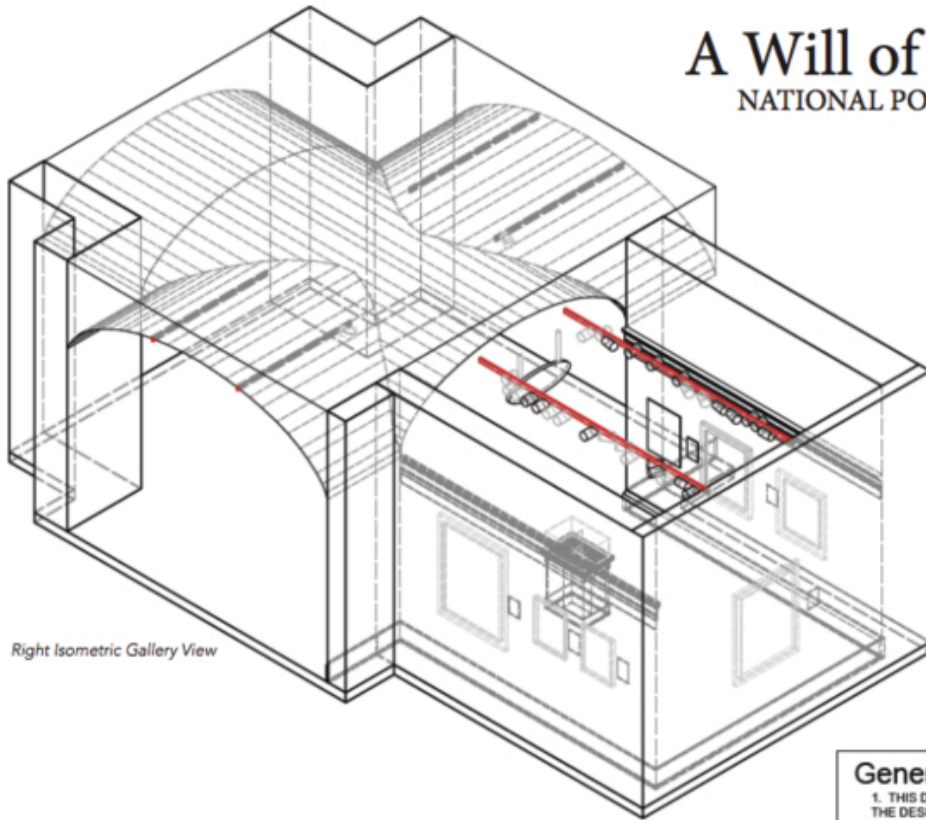

Right Isometric Gallery View



ACTUAL EXHIBITION

### KEY & LEGEND

#### KEY TO ACCESSORY TYPES

CODE	DESCRIPTION
55	55 DEGREE LENS
R132	LIGHT FROST GEL

#### KEY TO LAMP TYPES

CODE	LAMP CODE	DESCRIPTION	WATTAGE	HEIGHT
1	GE14553	VERY NARROW SPOT INCANDESCENT	5.5	25
2	GE14554	VERY NARROW SPOT INCANDESCENT	12	25
3	GE18060	SHORT NECK FLOOD	130	75
4	GE14553	VERY NARROW SPOT INCANDESCENT	6.0	25
5	PH229419	SHORT NECK FLOOD	120	75
6	GE16393	SHORT NECK FLOOD	120	75

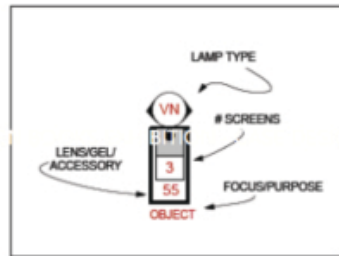

### General Notes

1. THIS DRAWING REPRESENTS DESIGN INTENT AND CONCEPT. THE DESIGNER IS RESPONSIBLE FOR VISUAL ASPECTS OF THIS INSTALLATION ONLY. ALL SPECIFICATIONS PROVIDED RELATE SOLELY TO THE APPEARANCE OF THE LIGHTING AND NOT TO MATTERS OF ELECTRICAL OR STRUCTURAL SOUNDNESS AND OR SAFETY. THE IMPLEMENTATION OF THIS DESIGN MUST COMPLY WITH THE MOST STRINGENT APPLICABLE FEDERAL AND LOCAL SAFETY AND FIRE CODES. THE DESIGNER IS NOT QUALIFIED TO DETERMINE ELECTRICAL STRUCTURAL APPROPRIATENESS OF THE DESIGN AND WILL NOT ASSUME RESPONSIBILITY FOR DAMAGE RESULTING THROUGH IMPROPER ENGINEERING AND OR IMPLEMENTATION IN THE HANDLING OF THE ELEMENTS OF THE LIGHTING DESIGN. THE DESIGNER AGREES TO MAKE PROMPT CORRECTING ALTERATIONS TO ANY SPECIFICATION FOUND TO BE INCOMPATIBLE WITH PROPER SAFETY PRECAUTIONS.

2. SEE FIXTURE SCHEDULE FOR ACCESSORY INFORMATION.

**PROJECT: A WILL OF THEIR OWN  
MICHAEL AND VICTORIS CALLEX GALLERY  
NATIONAL PORTRAIT GALLERY**

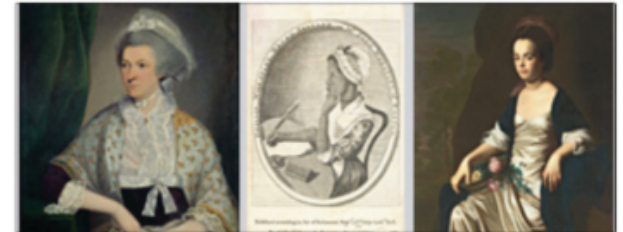

EXHIBITION OBJECTS

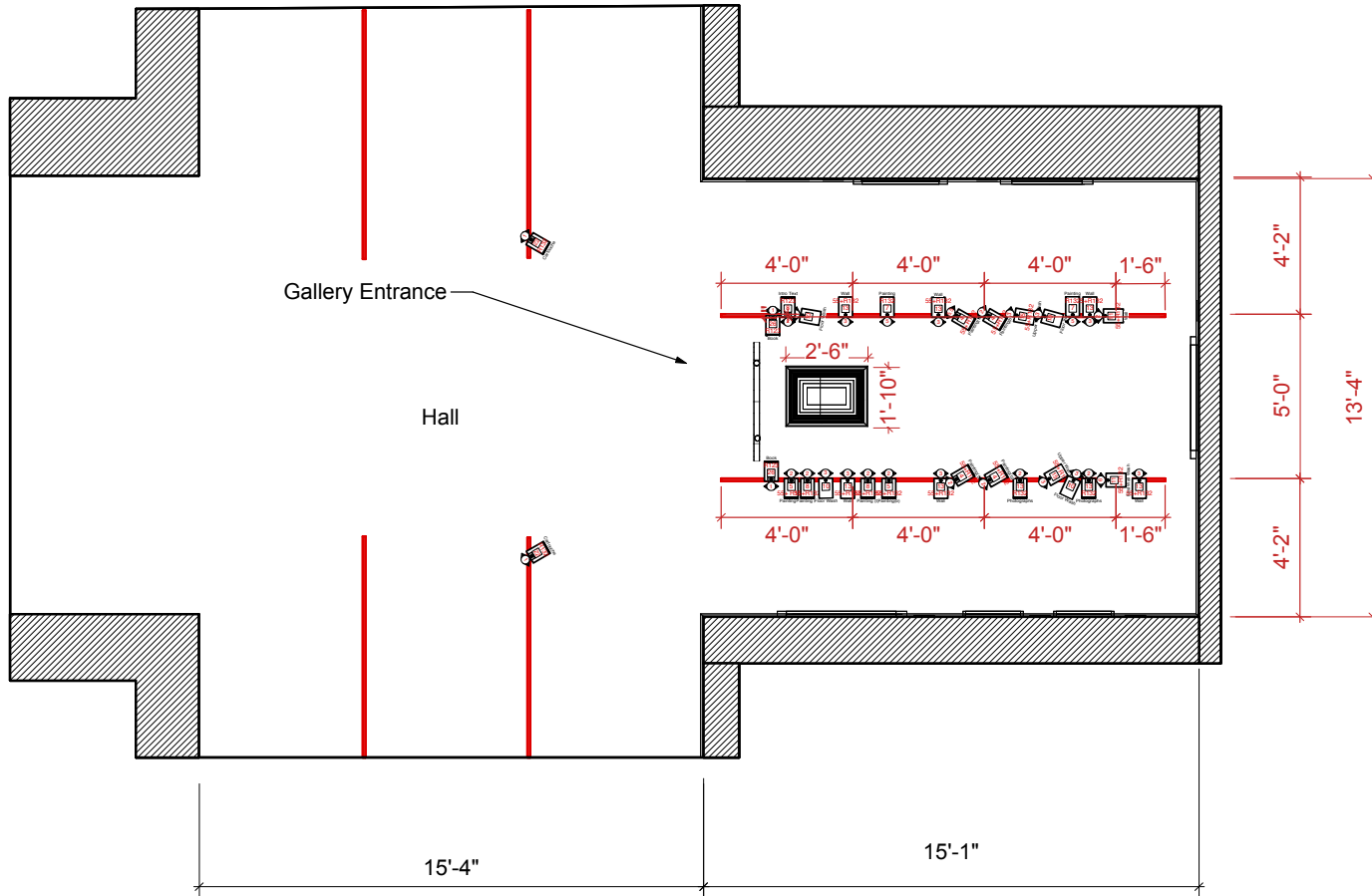

**NOTES**

Lighting Objective:  
 Wall wash = 3fc  
 Floor wash = 3fc  
 Photographs = 7 total fc  
 Book = 7 fc  
 Graphics = 9 fc  
 Oil paintings = 16fc

SCALE: AS NOTED

DATE: 05-08-2013

DESIGNER: JAY PASTORE

LIGHTING/EXHIBITIONS  
EX6110B

CORCORAN COLLEGE  
OF  
ART AND DESIGN

INSTRUCTOR: ALEX COOPER

1 Floor plan  
Sht. 1 Scale: 3/8" = 1'-0"

**KEY & LEGEND**

- TA FIXTURE WITH VERTICAL LAMPS/LENS
- TC FIXTURE WITH VERTICAL LAMPS/LENS

KEY TO ACCESSORY TYPES

CODE	DESCRIPTION
55	55 DEGREE LENS
R132	LIGHT FROST GEL

KEY TO LAMP TYPES

CODE	LAMP CODE	DESCRIPTION	VOLTAGE	WATTAGE
1	GE14553	VERY NARROW SPOT INCANDESCENT	5.5	25
2	GE14554	VERY NARROW SPOT INCANDESCENT	12	25
3	GE18060	SHORT NECK FLOOD	130	75
4	GE14553	VERY NARROW SPOT INCANDESCENT	6.0	25
5	PH229419	SHORT NECK FLOOD	120	75
6	GE16393	SHORT NECK FLOOD	120	75

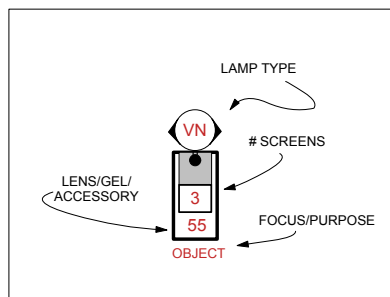

**General Notes**

1. THIS DRAWING REPRESENTS DESIGN INTENT AND CONCEPT. THE DESIGNER IS RESPONSIBLE FOR VISUAL ASPECTS OF THIS INSTALLATION ONLY. ALL SPECIFICATIONS PROVIDED RELATE SOLELY TO THE APPEARANCE OF THE LIGHTING AND NOT TO MATTERS OF ELECTRICAL OR STRUCTURAL SOUNDNESS AND OR SAFETY. THE IMPLEMENTATION OF THIS DESIGN MUST COMPLY WITH THE MOST STRINGENT APPLICABLE FEDERAL AND LOCAL SAFETY AND FIRE CODES. THE DESIGNER IS NOT QUALIFIED TO DETERMINE ELECTRICAL STRUCTURAL APPROPRIATENESS OF THE DESIGN AND WILL NOT ASSUME RESPONSIBILITY FOR DAMAGE RESULTING THROUGH IMPROPER ENGINEERING AND OR IMPLEMENTATION IN THE HANDLING OF THE ELEMENTS OF THE LIGHTING DESIGN. THE DESIGNER AGREES TO MAKE PROMPT CORRECTING ALTERATIONS TO ANY SPECIFICATION FOUND TO BE INCOMPATIBLE WITH PROPER SAFETY PRECAUTIONS.

2. SEE FIXTURE SCHEDULE FOR ACCESSORY INFORMATION.

PROJECT: A WILL OF THEIR OWN  
 MICHAEL AND VICTORIS CALLEX GALLERY  
 NATIONAL PORTRAIT GALLERY

202.714.2386  
jaypastore@mac.com



DRAWING:

01

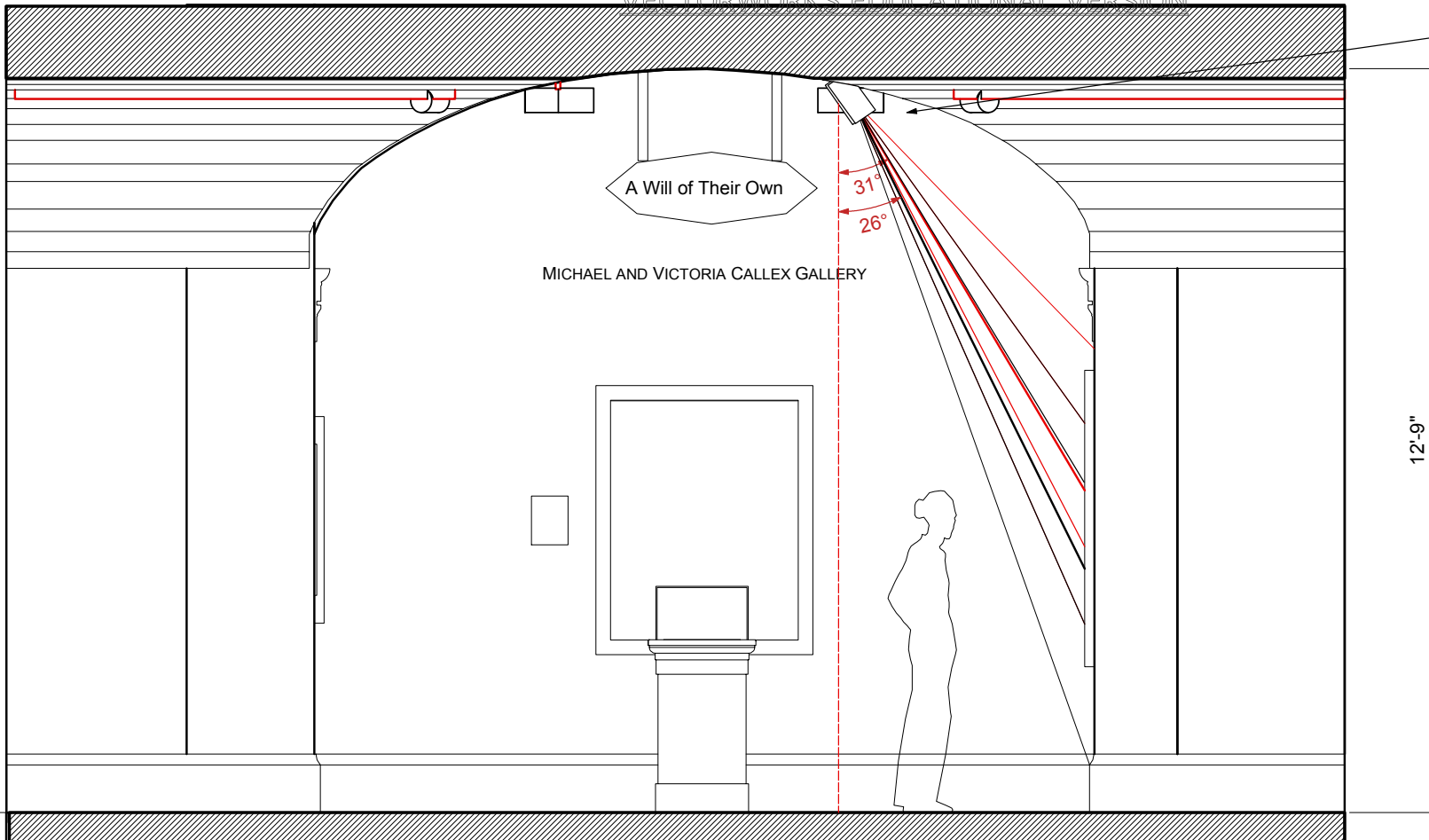

The light from the upper row of lamps for lighting this painting is indicated with red lines. The lower row lighting is indicated by black lines.

NOTES

SCALE: AS NOTED  
 DATE: 05-08-2013  
 DESIGNER: JAY PASTORE  
 LIGHTING/EXHIBITIONS  
 EX6110B  
 CORCORAN COLLEGE  
 OF  
 ART AND DESIGN  
 INSTRUCTOR: ALEX COOPER

1 NORTH/SOUTH SECTION FACING EAST  
 Sht-2 Scale: 3/4" = 1'-0"

General Notes

1. THIS DRAWING REPRESENTS DESIGN INTENT AND CONCEPT. THE DESIGNER IS RESPONSIBLE FOR VISUAL ASPECTS OF THIS INSTALLATION ONLY. ALL SPECIFICATIONS PROVIDED RELATE SOLELY TO THE APPEARANCE OF THE LIGHTING AND NOT TO MATTERS OF ELECTRICAL OR STRUCTURAL SOUNDNESS AND OR SAFETY. THE IMPLEMENTATION OF THIS DESIGN MUST COMPLY WITH THE MOST STRINGENT APPLICABLE FEDERAL AND LOCAL SAFETY AND FIRE CODES. THE DESIGNER IS NOT QUALIFIED TO DETERMINE ELECTRICAL STRUCTURAL APPROPRIATENESS OF THE DESIGN AND WILL NOT ASSUME RESPONSIBILITY FOR DAMAGE RESULTING THROUGH IMPROPER ENGINEERING AND OR IMPLEMENTATION IN THE HANDLING OF THE ELEMENTS OF THE LIGHTING DESIGN. THE DESIGNER AGREES TO MAKE PROMPT CORRECTING ALTERATIONS TO ANY SPECIFICATION FOUND TO BE INCOMPATIBLE WITH PROPER SAFETY PRECAUTIONS.

2. SEE FIXTURE SCHEDULE FOR ACCESSORY INFORMATION.

PROJECT: A WILL OF THEIR OWN  
 MICHAEL AND VICTORIA CALLEX GALLERY  
 NATIONAL PORTRAIT GALLERY

KEY & LEGEND

- TA FIXTURE WITH VERTICAL LAMPS/LENS
- TC FIXTURE WITH VERTICAL LAMPS/LENS

KEY TO ACCESSORY TYPES

CODE	DESCRIPTION
55	55 DEGREE LENS
R132	LIGHT FROST GEL

KEY TO LAMP TYPES

CODE	LAMP CODE	DESCRIPTION	VOLTAGE	WATTAGE
1	GE14553	VERY NARROW SPOT INCANDESCENT	5.5	25
2	GE14554	VERY NARROW SPOT INCANDESCENT	12	25
3	GE18060	SHORT NECK FLOOD	130	75
4	GE14553	VERY NARROW SPOT INCANDESCENT	6.0	25
5	PH229419	SHORT NECK FLOOD	120	75
6	GE16393	SHORT NECK FLOOD	120	75

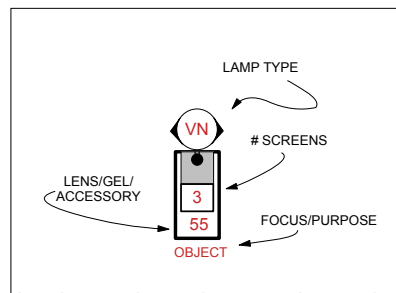

DRAWING:

02

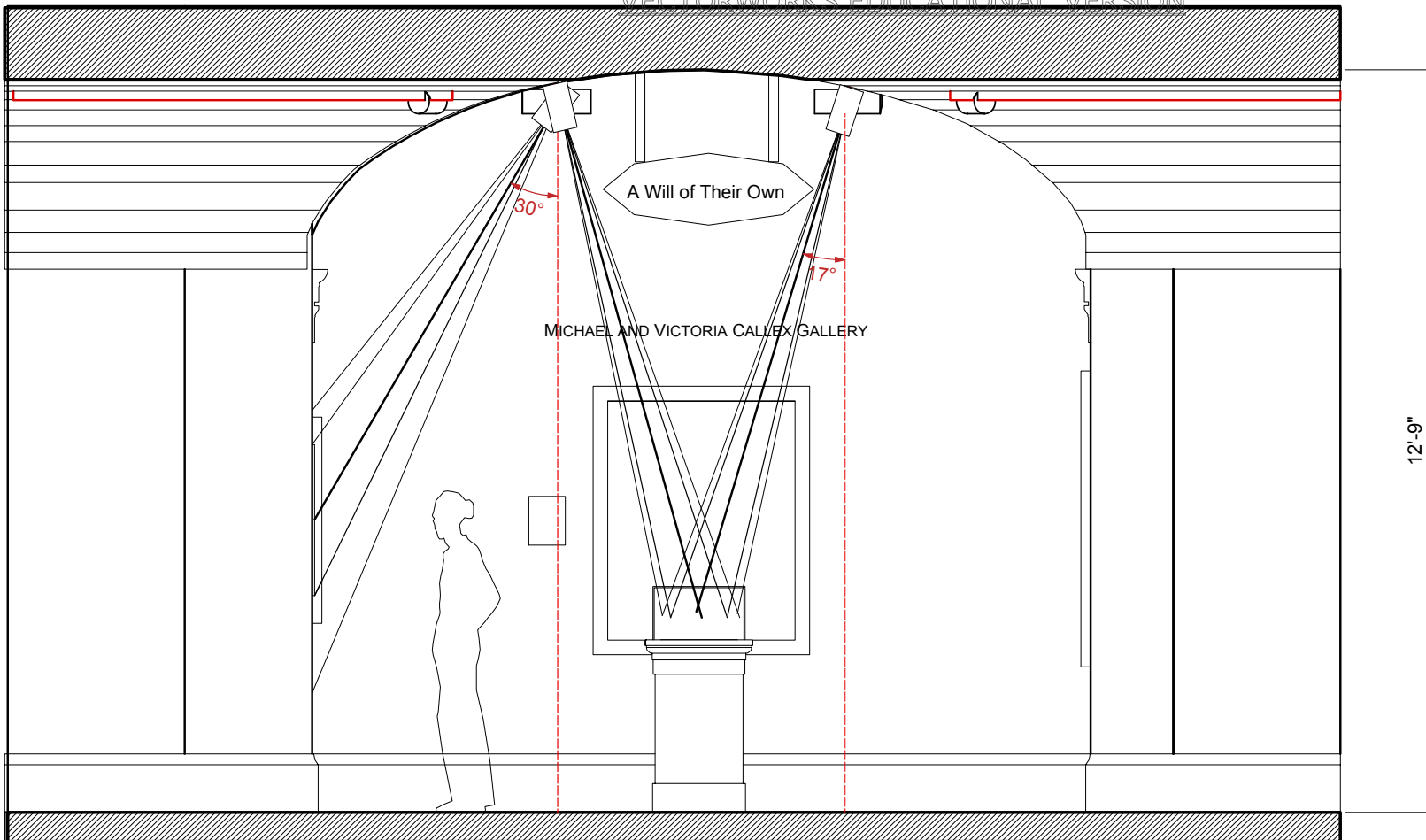

**NOTES**

Intro Panel lit at 7fc  
(not including the wall wash)

Each lamp illuminated the book with 3.5 ft. (total 7)

SCALE: AS NOTED

DATE: 05-08-2013

DESIGNER: JAY PASTORE

LIGHTING/EXHIBITIONS  
EX6110B

CORCORAN COLLEGE  
OF  
ART AND DESIGN

INSTRUCTOR: ALEX COOPER

1 [Drawing Title]  
Sht-3 Scale: 3/4" = 1'-0"

**KEY & LEGEND**

- TA FIXTURE WITH VERTICAL LAMPS/LENS
- TC FIXTURE WITH VERTICAL LAMPS/LENS

**KEY TO ACCESSORY TYPES**

CODE	DESCRIPTION
55	55 DEGREE LENS
R132	LIGHT FROST GEL

**KEY TO LAMP TYPES**

CODE	LAMP CODE	DESCRIPTION	VOLTAGE	WATTAGE
1	GE14553	VERY NARROW SPOT INCANDESENT	5.5	25
2	GE14554	VERY NARROW SPOT INCANDESENT	12	25
3	GE18060	SHORT NECK FLOOD	130	75
4	GE14553	VERY NARROW SPOT INCANDESENT	6.0	25
5	PH229419	SHORT NECK FLOOD	120	75
6	GE16393	SHORT NECK FLOOD	120	75

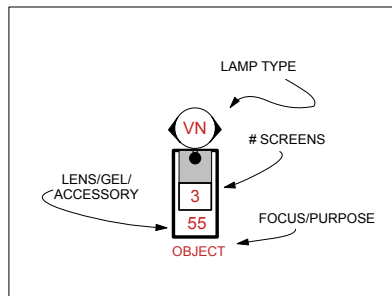

**General Notes**

1. THIS DRAWING REPRESENTS DESIGN INTENT AND CONCEPT. THE DESIGNER IS RESPONSIBLE FOR VISUAL ASPECTS OF THIS INSTALLATION ONLY. ALL SPECIFICATIONS PROVIDED RELATE SOLELY TO THE APPEARANCE OF THE LIGHTING AND NOT TO MATTERS OF ELECTRICAL OR STRUCTURAL SOUNDNESS AND OR SAFETY. THE IMPLEMENTATION OF THIS DESIGN MUST COMPLY WITH THE MOST STRINGENT APPLICABLE FEDERAL AND LOCAL SAFETY AND FIRE CODES. THE DESIGNER IS NOT QUALIFIED TO DETERMINE ELECTRICAL STRUCTURAL APPROPRIATENESS OF THE DESIGN AND WILL NOT ASSUME RESPONSIBILITY FOR DAMAGE RESULTING THROUGH IMPROPER ENGINEERING AND OR IMPLEMENTATION IN THE HANDLING OF THE ELEMENTS OF THE LIGHTING DESIGN. THE DESIGNER AGREES TO MAKE PROMPT CORRECTING ALTERATIONS TO ANY SPECIFICATION FOUND TO BE INCOMPATIBLE WITH PROPER SAFETY PRECAUTIONS.

2. SEE FIXTURE SCHEDULE FOR ACCESSORY INFORMATION.

PROJECT: A WILL OF THEIR OWN  
MICHAEL AND VICTORIS CALLEX GALLERY  
NATIONAL PORTRAIT GALLERY

DRAWING:

**03**

202.714.2388  
jaypastore@mac.com



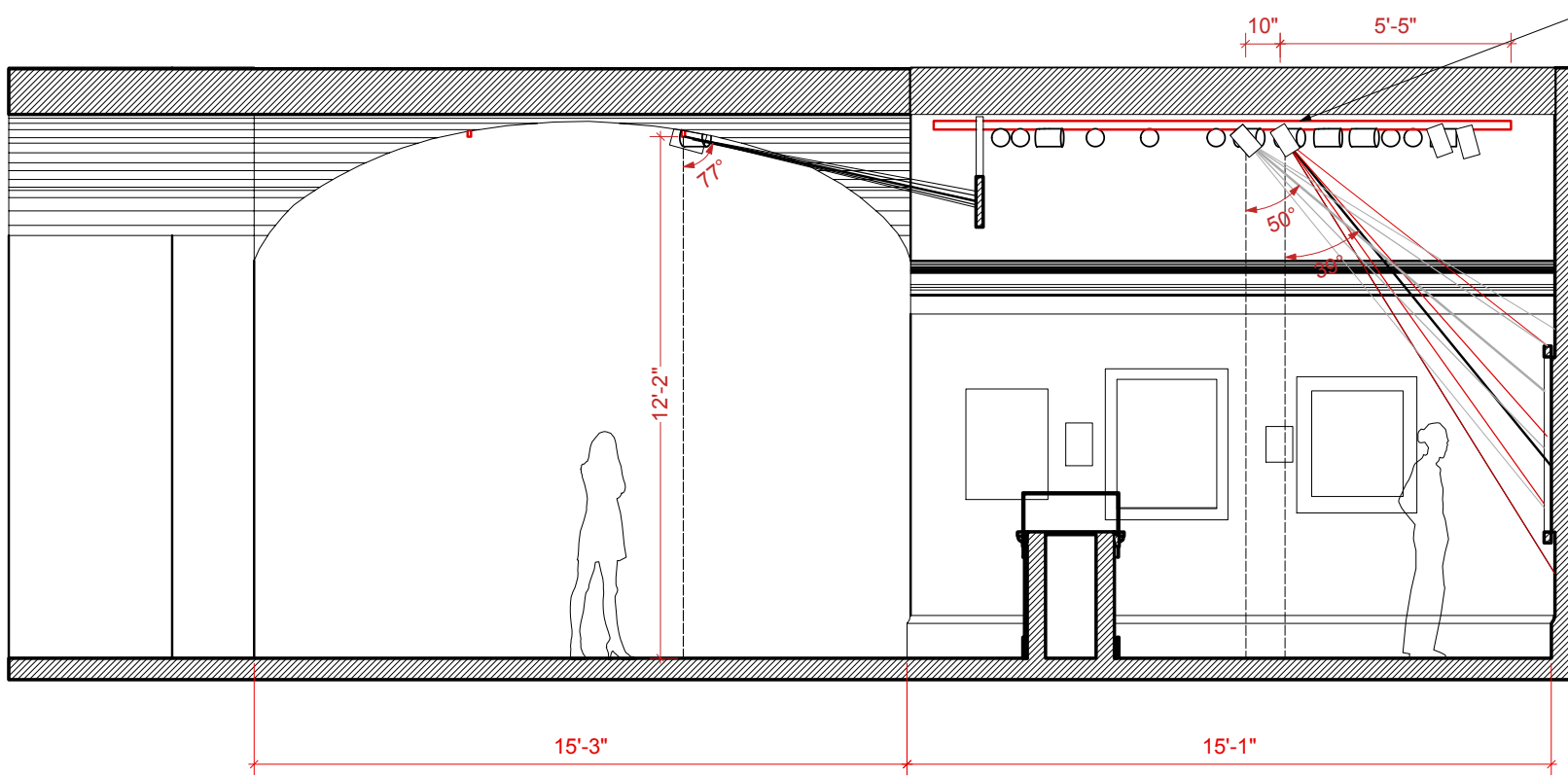

Lamp directed at lower 1/2 of painting has light denoted as red.  
Lamp directed at upper 1/2 of painting has light denoted as gray.

**NOTES**

Photometrics:  
Catrouche = 9 footcandles

On East wall oil painting= total of 16 footcandles  
(top and bottom section photometrics are the result of two overlapping lamps.)

SCALE: AS NOTED  
DATE: 05-08-2013  
DESIGNER: JAY PASTORE  
LIGHTING/EXHIBITIONS  
EX6110B

CORCORAN COLLEGE  
OF  
ART AND DESIGN  
INSTRUCTOR: ALEX COOPER

3 EAST/WEST SECTION  
Sht-4 Scale: 1/2" = 1'-0"

**KEY & LEGEND**

	TA FIXTURE WITH VERTICAL LAMPS/LENS
	TC FIXTURE WITH VERTICAL LAMPS/LENS

**KEY TO ACCESSORY TYPES**

CODE	DESCRIPTION
55	55 DEGREE LENS
R132	LIGHT FROST GEL

**KEY TO LAMP TYPES**

CODE	LAMP CODE	DESCRIPTION	VOLTAGE	WATTAGE
1	GE14553	VERY NARROW SPOT INCANDESCENT	5.5	25
2	GE14554	VERY NARROW SPOT INCANDESCENT	12	25
3	GE18060	SHORT NECK FLOOD	130	75
4	GE14553	VERY NARROW SPOT INCANDESCENT	6.0	25
5	PH229419	SHORT NECK FLOOD	120	75
6	GE16393	SHORT NECK FLOOD	120	75

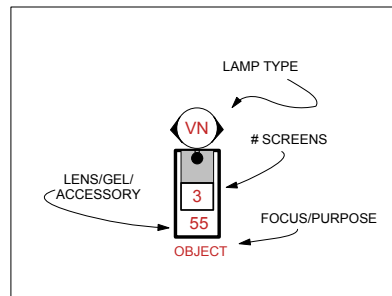

**General Notes**

1. THIS DRAWING REPRESENTS DESIGN INTENT AND CONCEPT. THE DESIGNER IS RESPONSIBLE FOR VISUAL ASPECTS OF THIS INSTALLATION ONLY. ALL SPECIFICATIONS PROVIDED RELATE SOLELY TO THE APPEARANCE OF THE LIGHTING AND NOT TO MATTERS OF ELECTRICAL OR STRUCTURAL SOUNDNESS AND OR SAFETY. THE IMPLEMENTATION OF THIS DESIGN MUST COMPLY WITH THE MOST STRINGENT APPLICABLE FEDERAL AND LOCAL SAFETY AND FIRE CODES. THE DESIGNER IS NOT QUALIFIED TO DETERMINE ELECTRICAL STRUCTURAL APPROPRIATENESS OF THE DESIGN AND WILL NOT ASSUME RESPONSIBILITY FOR DAMAGE RESULTING THROUGH IMPROPER ENGINEERING AND OR IMPLEMENTATION IN THE HANDLING OF THE ELEMENTS OF THE LIGHTING DESIGN. THE DESIGNER AGREES TO MAKE PROMPT CORRECTING ALTERATIONS TO ANY SPECIFICATION FOUND TO BE INCOMPATIBLE WITH PROPER SAFETY PRECAUTIONS.

2. SEE FIXTURE SCHEDULE FOR ACCESSORY INFORMATION.

PROJECT: A WILL OF THEIR OWN  
MICHAEL AND VICTORIS CALLEX GALLERY  
NATIONAL PORTRAIT GALLERY

DRAWING:

04

202.714.2388  
jaypastore@mac.com



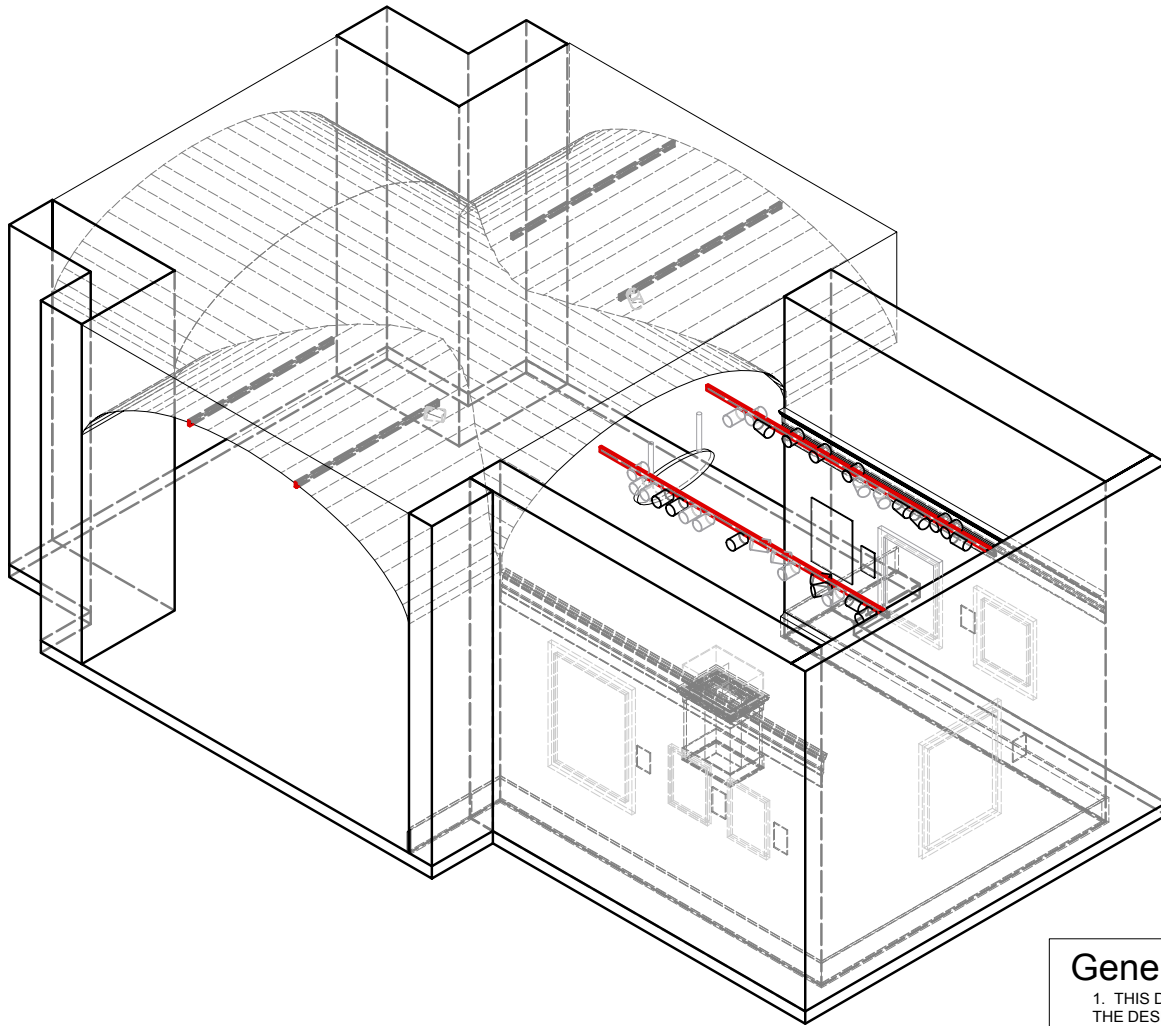

NOTES

SCALE: AS NOTED  
 DATE: 05-08-2013  
 DESIGNER: JAY PASTORE  
 LIGHTING/EXHIBITIONS  
 EX6110B  
 CORCORAN COLLEGE  
 OF  
 ART AND DESIGN  
 INSTRUCTOR: ALEX COOPER

KEY & LEGEND

	TA FIXTURE WITH VERTICAL LAMPS/LENS
	TC FIXTURE WITH VERTICAL LAMPS/LENS

KEY TO ACCESSORY TYPES

CODE	DESCRIPTION
55	55 DEGREE LENS
R132	LIGHT FROST GEL

KEY TO LAMP TYPES

CODE	LAMP CODE	DESCRIPTION	VOLTAGE	WATTAGE
1	GE14553	VERY NARROW SPOT INCANDESENT	5.5	25
2	GE14554	VERY NARROW SPOT INCANDESENT	12	25
3	GE18060	SHORT NECK FLOOD	130	75
4	GE14553	VERY NARROW SPOT INCANDESENT	6.0	25
5	PH229419	SHORT NECK FLOOD	120	75
6	GE16393	SHORT NECK FLOOD	120	75

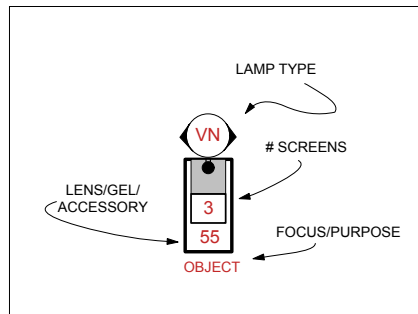

General Notes

- THIS DRAWING REPRESENTS DESIGN INTENT AND CONCEPT. THE DESIGNER IS RESPONSIBLE FOR VISUAL ASPECTS OF THIS INSTALLATION ONLY. ALL SPECIFICATIONS PROVIDED RELATE SOLELY TO THE APPEARANCE OF THE LIGHTING AND NOT TO MATTERS OF ELECTRICAL OR STRUCTURAL SOUNDNESS AND OR SAFETY. THE IMPLEMENTATION OF THIS DESIGN MUST COMPLY WITH THE MOST STRINGENT APPLICABLE FEDERAL AND LOCAL SAFETY AND FIRE CODES. THE DESIGNER IS NOT QUALIFIED TO DETERMINE ELECTRICAL STRUCTURAL APPROPRIATENESS OF THE DESIGN AND WILL NOT ASSUME RESPONSIBILITY FOR DAMAGE RESULTING THROUGH IMPROPER ENGINEERING AND OR IMPLEMENTATION IN THE HANDLING OF THE ELEMENTS OF THE LIGHTING DESIGN. THE DESIGNER AGREES TO MAKE PROMPT CORRECTING ALTERATIONS TO ANY SPECIFICATION FOUND TO BE INCOMPATIBLE WITH PROPER SAFETY PRECAUTIONS.
- SEE FIXTURE SCHEDULE FOR ACCESSORY INFORMATION.

PROJECT: A WILL OF THEIR OWN  
 MICHAEL AND VICTORIS CALLEX GALLERY  
 NATIONAL PORTRAIT GALLERY

202.714.2388  
 jaypastore@mac.com



DRAWING:

06